

Features & Benefits

- Complete Frost Protection – Unique Drain-Back™ heat exchange technology
- Complies with regulations in all states
- Booster – electric element
- Full Mains Pressure for multiple outlets
- 2 or 3 SPA2000 or CSA2007 collectors
- Eligible for STCs⁵
- 5 year cylinder warranty¹

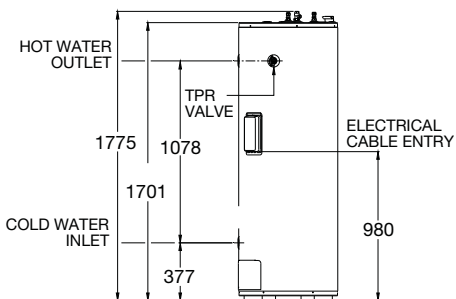

| MODEL | 591270 |
|--|----------------------------------|
| Storage Capacity (L) | 270 |
| Solar Collectors | 2 or 3 SPA2000 2 or 3 CSA2007 |
| Booster Type | Electric |
| Element size (kW) | 3.6 |
| Weight Empty (kg) - Tank | 168 |
| Weight Empty - (kg) Solar Collector (kg each) | 48 |
| Water Connections | Rp 3/4 |

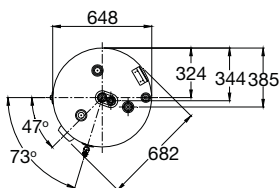

Scan code for
details & installation
instructions

