

### Features & Benefits

- Small diameter - 480mm
- Fast, easy like-for-like replacement
- Durable Rheem Ultraname<sup>®</sup>
- Designed for restricted space installations
- Dual handed connections
- Recessed plug fittings
- Australian made
- 12 year cylinder warranty<sup>1</sup>

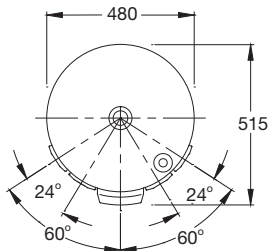

MODEL	491125
Hot Water Delivery (L)	125
kW Rating	1.8, 3.6
Relief Valve Pressure (kPa)	1400
Expansion Control Valve (kPa)	1200
<b>Max Water Supply Pressure:</b>	
with ECV (kPa)	960
without ECV (kPa)	1120
Water Connections	Rp <sup>3</sup> / <sub>4</sub>
Approx. Weight (packaged) kg	51

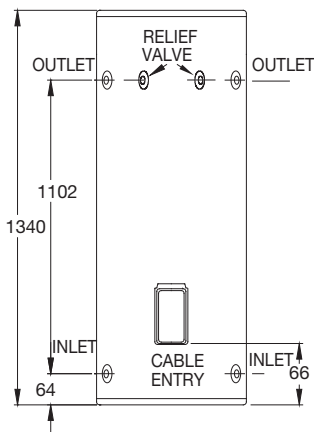

Tap QR code for  
installation  
instructions

