

Features & Benefits

- Small diameter - 480mm
- Fast, easy like-for-like replacement
- Exclusive Rheem Ultraname[®]
- Designed for restricted space installations
- Dual handed connections
- Recessed plug fittings
- Australian made
- 12 year cylinder warranty¹

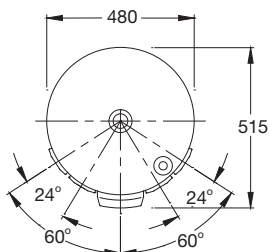

MODEL	491125
Hot Water Delivery (L)	125
kW Rating	1.8, 3.6
Relief Valve Pressure (kPa)	1400
Expansion Control Valve (kPa)	1200
Max Water Supply Pressure:	
with ECV (kPa)	960
without ECV (kPa)	1120
Water Connections	Rp ³ / ₄
Approx. Weight (packaged) kg	51

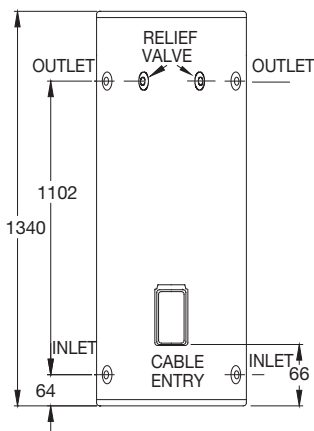

Scan code for
details & installation
instructions

